



Panorama Survey - Teacher Resources Fall 2024

The resources below provide detailed information about how to prepare and support students in taking the SEL survey

Proctor Guide

- [English](#)
- [Spanish](#)

Survey Access

- Between **September 23** and **October 25**, your school website will have a QUICKLINK posted for students to access the survey from their device.
- After clicking the link, they will be asked for an “**access code**” – they will enter their **EPS student id number**.
- Survey questions can be viewed in advance from the Student Support Services website | <https://www.everettsd.org/Page/38010>

Pre-Teach Lessons – Recommendation would be to do this a day or more before the survey.

Mini Vocabulary Lessons – These Lesson teach students how to understand the language used in questions and how to answer Likert Scale style questions.

- ◆ [English](#)
- ◆ [English & Spanish](#)

Helpful for Elementary
- and -
ML & Special Ed (all ages)

Mini Survey Taking Lesson – Mini lesson to review how to access the survey.

- ◆ [Everett Students – How to Take the Survey](#) (slides)
- ◆ [English Video](#) (direct link)

Language Translation Supports

Student SEL Translations

Survey Taking Experience

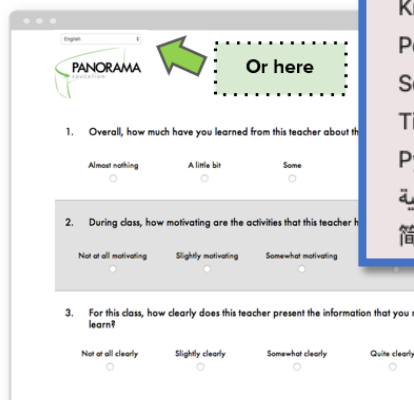
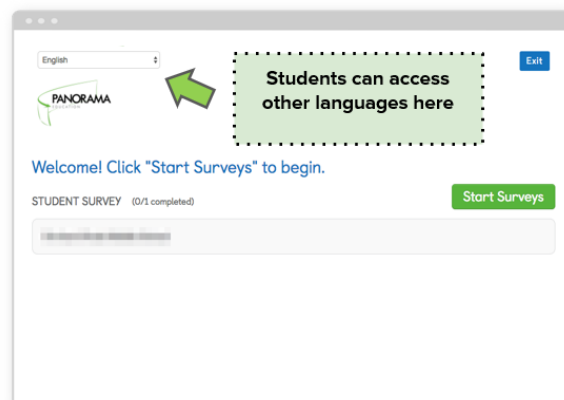

- ✓ English
- Español (Spanish)
- Kreyòl ayisyen (Haitian Creole)
- Português (Portuguese)
- Soomaali (Somali)
- Tiếng Việt (Vietnamese)
- Русский (Russian)
- العربية (Arabic)
- 简体中文 (Simplified Chinese)